

Revisions

Issue	Date	Note
4	07/01/2021	See note GTXPDC/246

ASSEMBLY VIEW

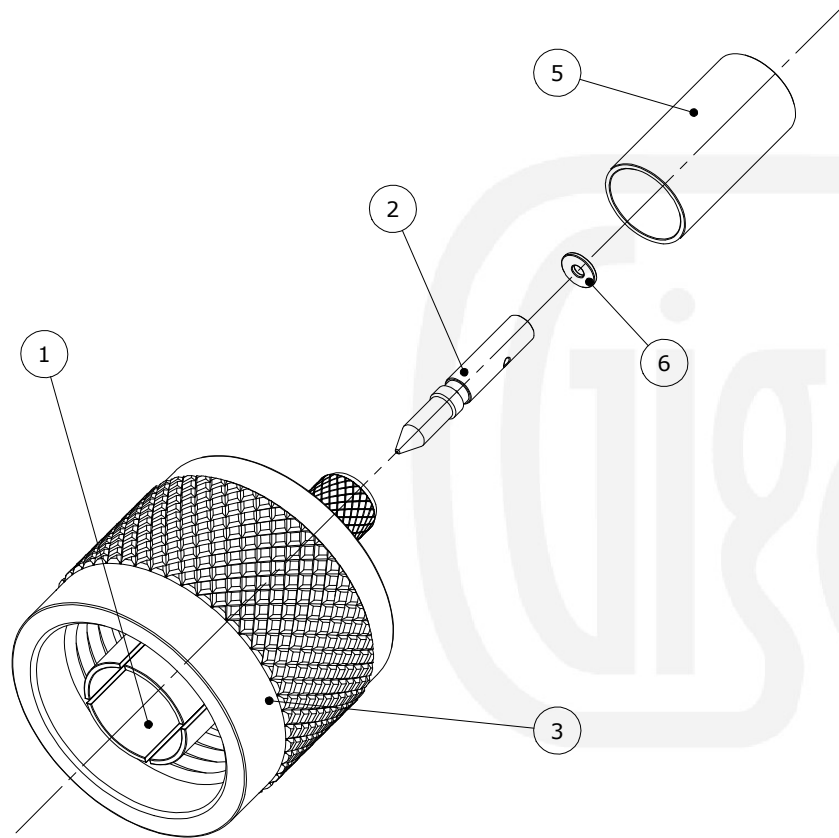

Assembly Instructions:

1) Slide the ferrule onto the cable and strip the cable to the dimensions as shown, taking care not to nick the centre conductor or braid.



2) Slide the insulator over the centre core (optional for cables without bonded foil) and then crimp the pin onto the centre core. Slide the pin into the body until fully captivated, ensuring that the cable braid is on the outside of the connector mandril.

3) Slide the ferrule forward and crimp.

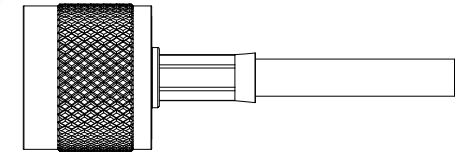

Crimp Hex. Sizes:

5.41mm Hex., 1.69mm Hex

Strip Dimensions:

A=8.0mm, B=3.0mm, C=3.5mm

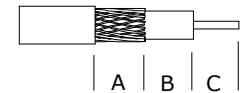

Description	Material	Finish
6 Insulator	PTFE	White
5 Ferrule	Brass	Nickel
4 Dielectric	PTFE	White
3 Coupling Nut	Brass	Nickel
2 Pin	Brass	Gold
1 Body	Brass	Nickel

Unless otherwise specified tolerances
 0.5-5 = ±0.2
 >5-30 = ±0.4
 >30-120 = ±0.6
 >120-315 = ±1.0
 >315-1000 = ±1.6
 Angles = ±5°
 Units = mm

This document is the confidential property of Gigatronix Limited and may not be copied, reproduced or transmitted to any third party without written authorisation.



Author	PJP
Drawn by	PJP
Drawing date	07/01/2021
Checked by	DB
Checked date	07/01/2021
Scale	2.5 : 1

Part Number NT15-0400-C06

Title: N Type Crimp Plug, Nickel Plated, RG142, RG223, RG400