

Revisions

Issue	Date	Note
2	26/09/2023	See GTXPDC/830

DATASHEET

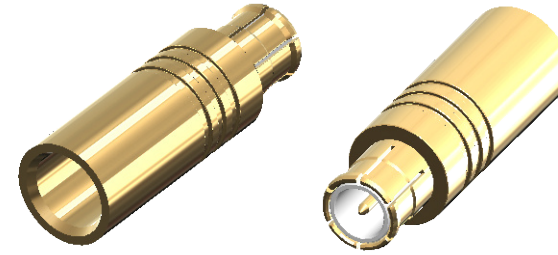

1. Mechanical

Fixing Method	Solder
Cable Retention	272N
Durability	500 mating cycles
Contact Retention	27N

2. Environmental

RoHS Compliant	Yes
Temperature Range	-65 to +165 degrees C

3. Electrical

Dielectric Withstanding	500 Volts RMS Maximum
Impedance	50 ohms
Interface Frequency	6 GHz
Working Voltage	250 Volts RMS Maximum

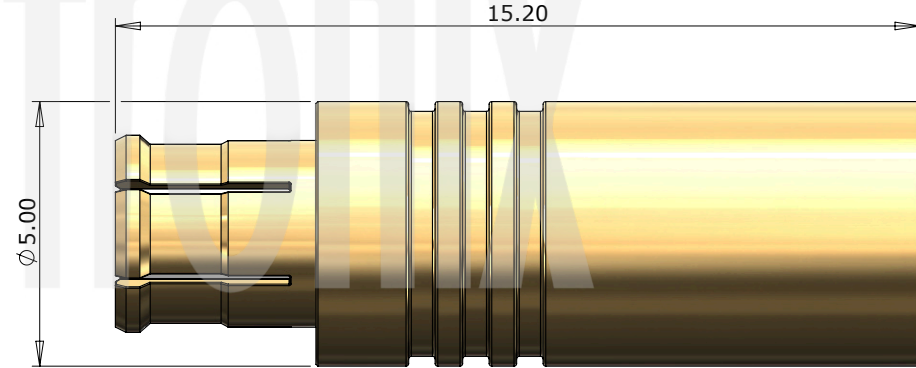

3	Dielectric	PTFE	White
2	Pin	Brass	Gold
1	Body	Brass / Beryllium Copper	Gold
	Description	Material	Finish

Unless otherwise specified tolerances
 0.5-5 = ±0.2
 >5-30 = ±0.4
 >30-120 = ±0.6
 >120-315 = ±1.0
 >315-1000 = ±1.6
 Angles = ±5°
 Units = mm

This document is the confidential property of Gigatronix Limited and may not be copied, reproduced or transmitted to any third party without written authorisation.



Author	PJP
Drawn by	PJP
Drawing date	07/02/2023
Checked by	DB
Checked date	14/02/2023
Scale	Not to scale

Part Number MX15-0402-R01
Title: MCX Solder Plug, Gold Plated, 50 ohms, .141 Semi-rigid, RG402 Conformable

Revisions

Issue	Date	Note
2	26/09/2023	See GTXPDC/830

DATASHEET

Assembly Instructions:

1) Strip the cable to the dimensions as shown, taking care not to nick the centre conductor



2) Solder the pin onto the centre core and slide the pin into the body, ensuring it is fully located

3) Solder the outer shield of the cable to the connector mandril



Strip Dimensions:

Conformable Cable - A=0.5mm, B=2.5mm
Semi Rigid Cable (using a 0.5mm spacer) - A=0.0mm, B=3.0mm

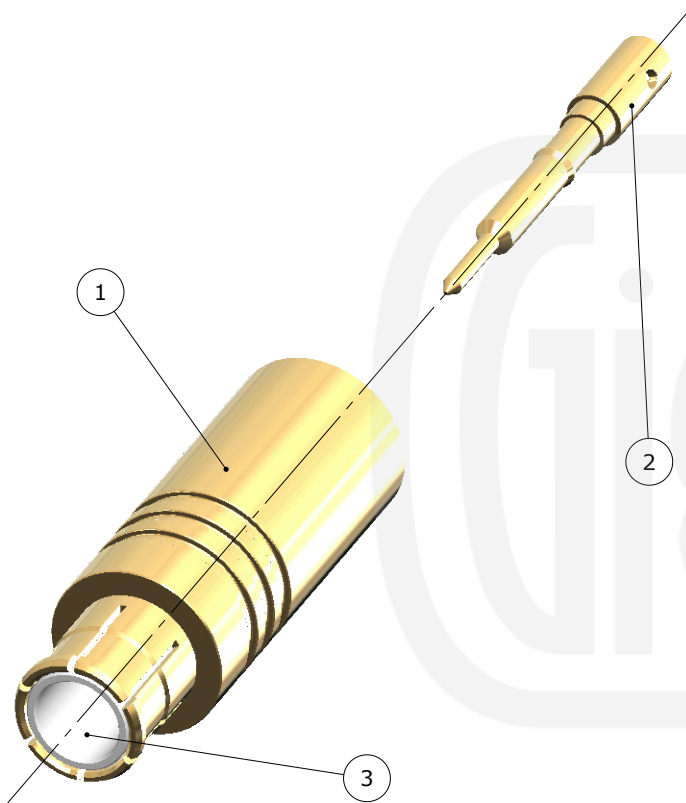
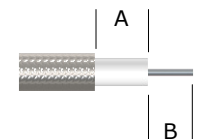

Description	Material	Finish
3 Dielectric	PTFE	White
2 Pin	Brass	Gold
1 Body	Brass / Beryllium Copper	Gold

Unless otherwise specified tolerances
 0.5-5 = ±0.2
 >5-30 = ±0.4
 >30-120 = ±0.6
 >120-315 = ±1.0
 >315-1000 = ±1.6
 Angles = ±5°
 Units = mm

This document is the confidential property of Gigatronix Limited and may not be copied, reproduced or transmitted to any third party without written authorisation.



Part Number | MX15-0402-R01
Title: MCX Solder Plug, Gold Plated, 50 ohms, .141 Semi-rigid, RG402 Conformable

Author	PJP
Drawn by	PJP
Drawing date	07/02/2023
Checked by	DB
Checked date	14/02/2023
Scale	Not to scale