

Revisions

Issue	Date	Note
1	29/07/2020	See GTXPDC/178

ASSEMBLY VIEW

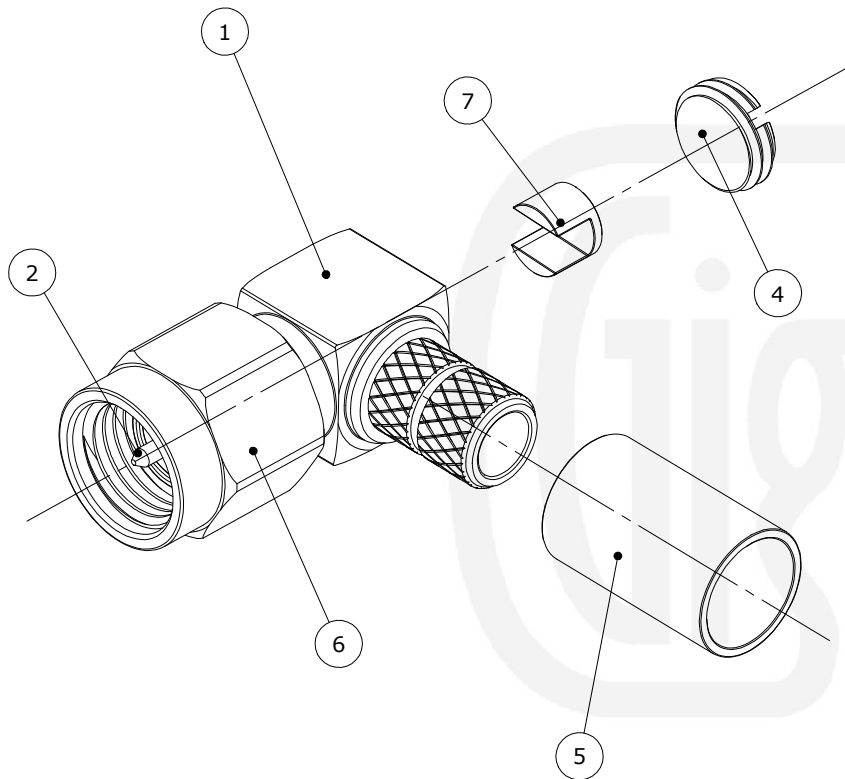

Assembly Instructions

1) Slide the ferrule onto the cable and strip the cable to the dimensions as shown, taking care not to nick the centre conductor or braid.

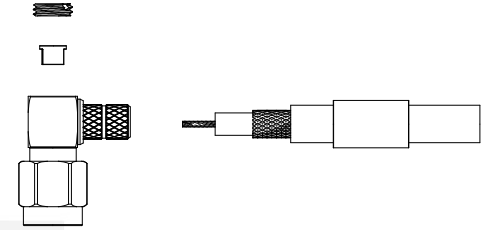

2) Insert the cable into the body, ensuring that the cable braid is on the outside of the connector mandril and that the centre core locates in the internal mounting post.

3) Slide the ferrule forward and crimp. Solder the centre core of the cable to the mounting post and fit the insulator and end cap.

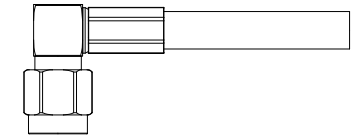

Crimp Hex. Sizes:

5.41mm Hex, Solder centre core

Strip Dimensions:

A=6.5mm, B=3.0mm, C=2.0mm

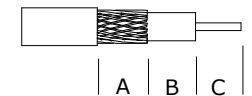

7	Insulator	ABS	White
6	Coupling Nut	Brass	Gold
5	Ferrule	Brass	Gold
4	End Cap	Brass	Gold
3	Dielectric	PTFE	White
2	Pin	Brass	Gold
1	Body	Brass	Gold
	Description	Material	Finish

Unless otherwise specified tolerances
 0.5-5 = ±0.2
 >5-30 = ±0.4
 >30-120 = ±0.6
 >120-315 = ±1.0
 >315-1000 = ±1.6
 Angles = ±5°
 Units = mm

This document is the confidential property of Gigatronix Limited and may not be copied, reproduced or transmitted to any third party without written authorisation.



Author	PJP
Drawn by	PJP
Drawing date	29/07/2020
Checked by	SM
Checked date	18/11/2020
Scale	Not to scale

Part Number	MA17-0058-C01
Title:	SMA Crimp Right Angle Plug, Gold Plated, RG58, LBC195, URM43