

**Revisions**

Issue	Date	Note
1	24/03/2025	See GTXPDC/1070

**DATASHEET**



**1. Mechanical**

Fixing Method	PCB
Durability	500 mating cycles
Lock Nut Torque	4.0 - 4.5Nm (35-40 in-lbs)
Recommended PCB Thickness	1.57mm
Contact Gender	Female

**2. Environmental**

RoHS Compliant	Yes
Temperature Range	-65 to +165 degrees C

**3. Electrical**

Dielectric Withstanding	1500 Volts RMS Maximum
Impedance	75 ohms
Interface Frequency	12 GHz
Working Voltage	500 Volts RMS Maximum

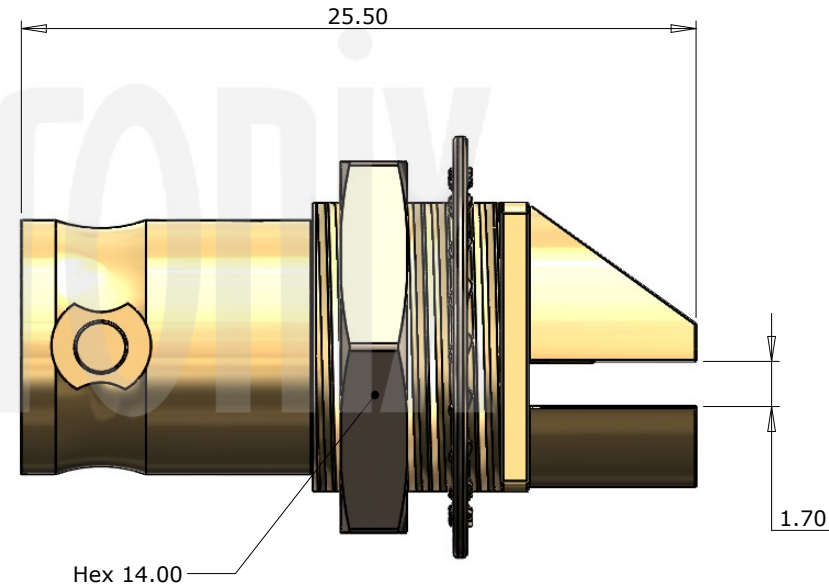
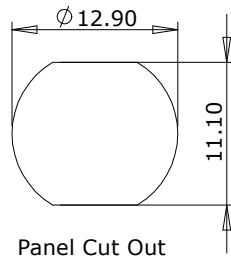

Description	Material	Finish
5 Lock Nut	Brass	Nickel
4 Washer	SK5	Nickel
3 Insulator	PTFE	White
2 Contact	Phosphor Bronze	Gold
1 Body	Brass	Gold

Unless otherwise specified tolerances  
 0.5-6 = ±0.2  
 >6-30 = ±0.4  
 >30-120 = ±0.6  
 >120-315 = ±1.0  
 >315-1000 = ±1.6  
 Angles = ±5°  
 Units = mm

This document is the confidential property of Gigatronix Limited and may not be copied, reproduced or transmitted to any third party without written authorisation.



**Part Number** BN02-X800-N01-38

**Title:** BNC 12G SDI End Launch Bulkhead Jack, Brass Body, Gold Plated, 1.57mm PCB, Hexagonal Locknut

<b>Author</b>	PJP
<b>Drawn by</b>	PJP
<b>Drawing date</b>	24/03/2025
<b>Checked by</b>	DB
<b>Checked date</b>	25/03/2025
<b>Scale</b>	Not to scale